



Manufacturing Intelligent Compressed Air Products Since 1983
 11510 Goldcoast Drive, Cincinnati, OH, USA 45249-1621
 (513) 671-3322 FAX (513) 671-3363 Email: techelp@exair.com

MODEL 9076 UNIVERSAL AIR KNIFE PLUMBING KIT INSTALLATION & MAINTENANCE

This Model 9076 Universal Air Knife Plumbing Kit is used to interconnect the compressed air inlets on each end of any single Air Knife that has a length up to 42" (1067mm). The components of this kit have been sized appropriately to obtain best performance from the Air Knife (maintain uniform airflow across the entire length).

The Model 9077 Universal Air Knife Plumbing Kit should be used for lengths from 42" (1067mm) – 54" (1372mm).

The Model 9078 Universal Air Knife Plumbing Kit should be used for lengths from 60" (1524mm) - 84" (2134mm).

The Model 9079 Universal Air Knife Plumbing Kit should be used for lengths over 84" (2134mm). Air Knives less than 24" (610mm) can be supplied at one compressed air inlet. See Lit 2111 and 2112 for Stainless Steel Air Knife Plumbing Kits.

To connect bottom compressed air inlets, use this diagram.

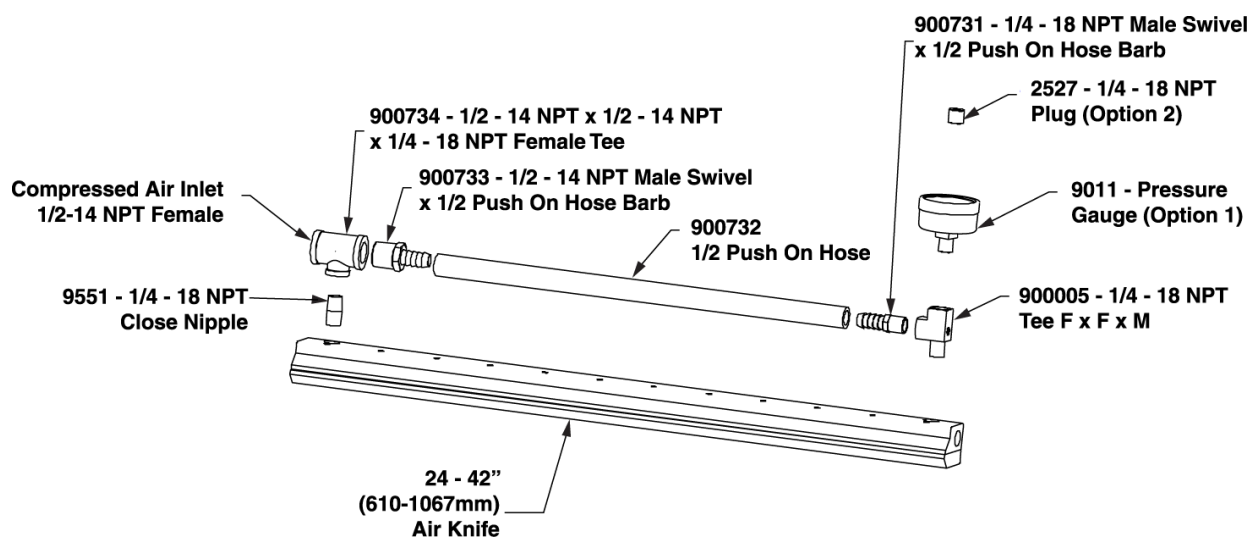

Pipe thread sealant should be applied to all threads (small packet included). Avoid the inside diameter of the fitting so it does not enter into the Air Knife.

STEP 1 – Install the Model 9551 ¼ NPT Close Nipple into the compressed air inlet on the bottom of the Air Knife. This goes on the end that will be connected to the plant compressed air supply.

STEP 2 – Install the Model 900734 ½ x ½ x ¼ NPT female pipe Tee on to that Model 9551 Close Nipple and tighten. Be sure the ½ NPT female connections are directed toward the ends of the Air Knife.

STEP 3 – Install the Model 900005 ¼ NPT male/female pipe Tee into the compressed air inlet on the opposite end of the Air Knife (installing the male NPT connection of the pipe Tee into the Air Knife). Tighten and direct the ¼ NPT female connection toward the opposite end of the Air Knife.

STEP 4 – Hand tighten the Model 900733 ½ NPT x ½ hose barb into the Model 900734 ½ x ½ x ¼ NPT female Pipe Tee opposite the side where the plant compressed air will be supplied. On the Model 900005 Tee at the opposite end of the Air Knife, hand tighten the Model 900731 ¼ NPT x ½ hose barb into the inlet that points directly at the other barb fitting.

STEP 5 – Determine the length of hose that is necessary by measuring from outside the yellow collar of the one barb fitting to the outside the yellow collar on the opposite fitting. For a tight hose, cut the hose to this exact length. (Increasing the hose length will result in a loose hose).

STEP 6 – Remove hand tightened barb fittings and push the hose on to the hose barbs. You may use a glycerin based lubricant such as soap (not included). **DO NOT USE AN OIL BASED LUBRICANT TO INSTALL THE FITTINGS.**

STEP 7 – Install and tighten the ¼ NPT male end of the hose into the Model 900005 ¼ NPT female Tee connection. Install and tighten the ½ NPT male end of the hose into the Model 900734 ½ NPT female Tee connection.

STEP 8 – A Model 9011 Pressure Gauge is provided to monitor the pressure at the Air Knife. You may choose to install it or the Model 2527 Pipe Plug into the remaining ¼ NPT female connection of the Model 900005 Tee. Your Air Knife is now ready for installation.

To connect compressed air inlets on each end, use this diagram.

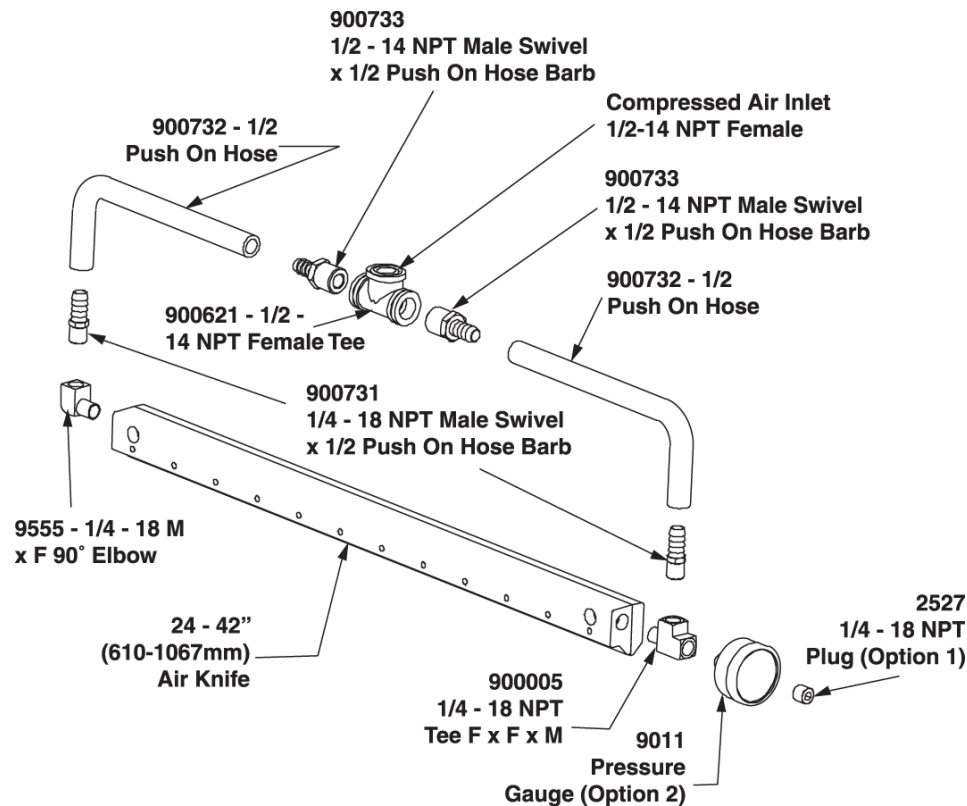

Pipe thread sealant should be applied to all threads (small packet included). Avoid the inside diameter of the fitting so it does not enter into the Air Knife.

STEP 1 – Install the male ¼ NPT thread of the Model 900005 Tee into the compressed air inlet on one end of the Air Knife.

STEP 2 – Install the Model 9555 ¼ NPT male x ¼ NPT female 90 degree Elbow into the compressed air inlet on the opposite end of the Air Knife.

STEP 3 – Hand tighten the (2) Model 900731 ¼ NPT x ½ Hose Barbs into the Model 900005 ¼ NPT male/female pipe Tee on the one end and into the Model 9555 ¼ NPT male x ¼ NPT female 90 degree Elbow on the other.

STEP 4 – Using the (2) Model 900733 ½ NPT x ½ Hose Barbs, hand tighten one into each side of the Model 900621 ½ NPT female pipe Tee. Place the hand tightened assembly at the center of the Air Knife.

STEP 5 – Determine the length of hose necessary by measuring from outside the yellow collar on the Model 900733 ½ NPT x ½ Hose Barb to the hex portion of the Model 900731 ¼ NPT x ½ Hose Barb. Add two inches to your measurement to avoid any potential kinks in the hose. Cut the hose to this length.

STEP 6 - Remove hand tightened barb fittings and push the hose on to the hose barbs. You may use a glycerin based lubricant such as soap (not included). **DO NOT USE AN OIL BASED LUBRICANT TO INSTALL THE FITTINGS.**

STEP 7 – Install and tighten the Model 900731 ¼ NPT male fittings into the ¼ NPT female Elbows. Install and tighten the Model 900733 ½ NPT male connections into opposite ends of the Model 900621 ½ NPT pipe Tee.

STEP 8 - A Model 9011 Pressure Gauge is provided to monitor the pressure at the Air Knife. You may choose to install it or the Model 2527 Pipe Plug into the remaining ¼ NPT female connection of the Model 900005 Tee. Your Air Knife is now ready for installation.

If you have any questions or problems, please contact:

YOUR INFO HERE:

Company Name
FAX:

Telephone
Email:

Website:



Manufacturing Intelligent Compressed Air Products Since 1983
11510 Goldcoast Drive, Cincinnati, OH, USA 45249-1621
(513) 671-3322 FAX (513) 671-3363 Email: techhelp@exair.com

MODEL 9077 UNIVERSAL AIR KNIFE PLUMBING KIT INSTALLATION & MAINTENANCE

This Model 9077 Universal Air Knife Plumbing Kit is used to interconnect the compressed air inlets on each end of any single Air Knife that has a length over 42" (1067mm) through 54" (1372mm). The components of this kit have been sized appropriately to obtain best performance from the Air Knife (maintain uniform airflow across the entire length).

The Model 9076 Universal Air Knife Plumbing Kit should be used for lengths from 24" (610mm) - 42" (1067mm). The Model 9078 Universal Air Knife Plumbing Kit should be used for lengths from 60" (1524mm) - 84" (2134mm). The Model 9079 Universal Air Knife Plumbing Kit should be used for lengths over 84" (2134mm). Air Knives less than 24" (610mm) can be supplied at one compressed air inlet. See Lit 2111 and 2112 for Stainless Steel Air Knife Plumbing Kits.

To connect bottom compressed air inlets, use this diagram.

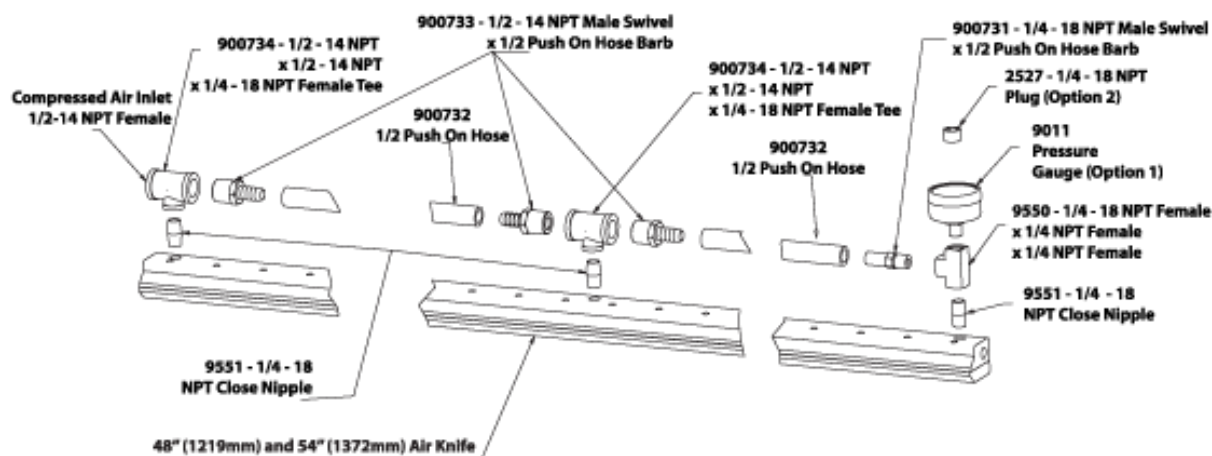

Pipe thread sealant should be applied to all threads (small packet included). Avoid the inside diameter of the fitting so it does not enter into the Air Knife.

- STEP 1** – Install the Model 9551 ¼ NPT Close Nipple into the compressed air inlet on the bottom of the Air Knife on the end that will be connected to the plant compressed air supply. Install another Model 9551 ¼ NPT Close Nipple into the center inlet of the Air Knife.
- STEP 2** – Using the (2) Model 900734 ½ x ½ x ¼ NPT female pipe Tees, install one onto each Model 9551 Close Nipple and tighten with ½ NPT female connections directed to the ends of the Air Knife.
- STEP 3** – Install a Model 9551 Close Nipple into the remaining bottom inlet of the Air Knife. Install a Model 9550 pipe Tee onto the Model 9551 Close Nipple and tighten so the ¼ NPT female connection is directed to the opposite end of the Air Knife.
- STEP 4** – Using the (3) Model 900733 ½ NPT x ½ Hose Barb fittings, hand tighten them into all the ½ NPT female connections of the two Model 900734 ½ x ½ x ¼ NPT female Pipe Tees as shown. Hand tighten the Model 900731 ¼ NPT x ½ Hose Barb into the horizontal ¼ NPT female thread on Model 9551 ¼ NPT pipe Tee.
- STEP 5** – Determine the length of hose that is necessary by measuring from outside the yellow collar of the one barb fitting to the outside the yellow collar on the opposite fitting. For a tight hose, cut the hose to this exact length. (Increasing the hose length will result in a loose hose). **NOTE: The two hose lengths on a 54" (1372mm) Super Air Knife will be different from each other due to the location of the center inlet.**

STEP 6 – Remove hand tightened barb fittings and push the hose on to the hose barbs. You may use a glycerin based lubricant such as soap (not included). **DO NOT USE AN OIL BASED LUBRICANT TO INSTALL THE FITTINGS.**

STEP 7 – Install and tighten the ¼ NPT male ends of the hose into the Model 9551 ¼ NPT female Tee connections. Install and tighten the ½ NPT male end of the hose into the Model 900734 ½ NPT female Tee connection.

STEP 8 – A Model 9011 Pressure Gauge is provided to monitor the pressure at the Air Knife. You may choose to install it or the Model 2527 Pipe Plug into the remaining ¼ NPT female connection of the Model 9551 Tee. Your Air Knife is now ready for installation.

To connect compressed air inlets on each end and the center, use this diagram.

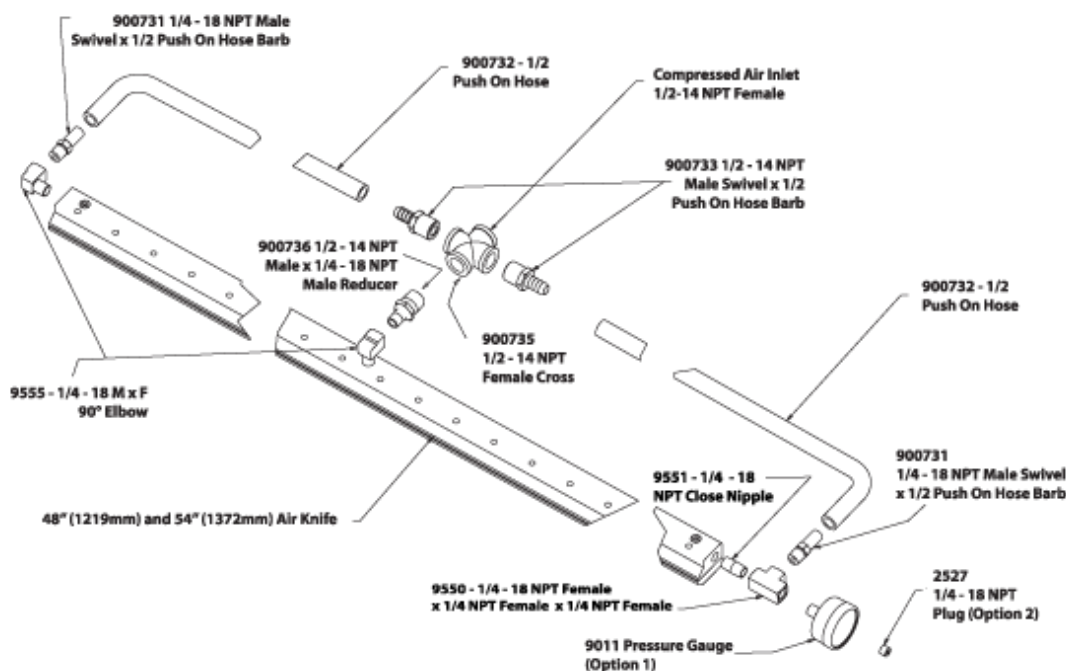

Pipe thread sealant should be applied to all threads (small packet included). Avoid the inside diameter of the fitting so it does not enter into the Air Knife.

STEP 1 - Install the Model 9550 ¼ NPT Close Nipple into the compressed air inlet on one end of the Air Knife. Install a Model 9550 Tee onto the Model 9551 Close Nipple.

STEP 2 – Using the (2) Model 9555 ¼ NPT male x ¼ NPT female 90 degree Elbows, install one into the bottom center compressed air inlet of the Air Knife. Install the second elbow into the compressed air inlet at the opposite end of the Air Knife.

STEP 3 –Using the (2) Model 900731 ¼ NPT x ½ Hose Barbs, hand tighten one into the Model 9550 ¼ NPT pipe Tee, and the other into the Model 9555 ¼ NPT male x ¼ NPT female 90 degree Elbow on the opposite end as shown.

STEP 4 – Install the Model 900736 ¼ NPT male to ½ NPT male Reducer into the Model 9555 ¼ NPT male x ¼ NPT female 90 degree Elbow that was previously installed in the bottom center compressed air inlet of the Air Knife. Install the Model 900735 ½ NPT female Cross onto the Model 900736 ¼ NPT male to ½ NPT male Reducer.

STEP 5 –Using the (2) Model 900733 ½ NPT x ½ Hose Barbs, hand tighten them into the opposite ends of the Model 900735 ½ NPT female Cross as shown.

STEP 6 - Determine the length of hose necessary by measuring from outside the yellow collar on the Model 900733 ½ NPT x ½ Hose Barb to the hex portion of the Model 900731 ¼ NPT x ½ Hose Barb. Add two inches to your measurement to avoid any potential kinks in the hose. Cut the hose to this length. **NOTE: The two hose lengths on a 54" (1372mm) Super Air Knife will be different from each other due to the location of the center**

STEP 7 - Remove hand tightened barb fittings and push the hose on to the hose barbs. You may use a glycerin based lubricant such as soap (not included). **DO NOT USE AN OIL BASED LUBRICANT TO INSTALL THE FITTINGS.**

STEP 8 - Install and tighten the ¼ NPT male fittings into the ¼ NPT female elbows. Install and tighten the ½ NPT male connections into the ½ NPT female cross.

STEP 9 - A Model 9011 Pressure Gauge is provided to monitor the pressure at the Air Knife. You may choose to install it or the Model 2527 Pipe Plug into the remaining ¼ NPT female connection of the Model 9551 pipe Tee. Your Air Knife is now ready for installation.

If you have any questions or problems, please contact:

YOUR INFO HERE:

Company Name

Telephone

FAX:

Email:

Website:



Manufacturing Intelligent Compressed Air Products Since 1983

11510 Goldcoast Drive, Cincinnati, OH, USA 45249-1621

(513) 671-3322 FAX (513) 671-3363 Email: techelp@exair.com

MODEL 9078 UNIVERSAL AIR KNIFE PLUMBING KIT INSTALLATION & MAINTENANCE

This Model 9078 Universal Air Knife Plumbing Kit is used to interconnect the compressed air inlets on the bottom of a 60" (1524mm) - 84" (2134mm) Air Knife. The components of this kit have been sized appropriately to obtain best performance from the Air Knife (maintain uniform airflow across the entire length).

The Model 9076 Universal Air Knife Plumbing Kit should be used for lengths from 24" (610mm) - 42" (1067mm). The Model 9077 Universal Air Knife Plumbing Kit should be used for lengths from 42" (1067mm) - 54" (1372mm). The Model 9079 Universal Air Knife Plumbing Kit should be used for lengths over 84" (2134mm). Air Knives less than 24" (610mm) can be supplied at one compressed air inlet. See Lit 2111 and 2112 for Stainless Steel Air Knife Plumbing Kits.

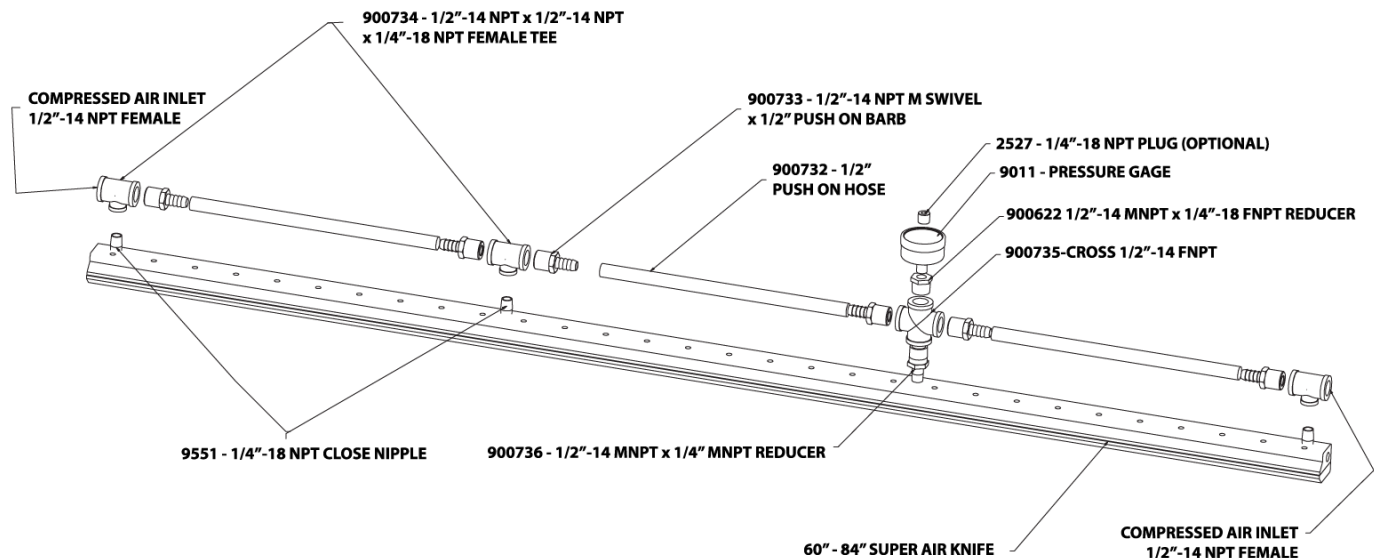

Pipe thread sealant should be applied to all threads (small packet included). Avoid the inside diameter of the fitting so it does not enter into the Air Knife.

STEP 1 – In a center inlet, install Model 900736 ½ MNPT x ¼ MNPT Reducer. Install Model 9551 ¼ NPT Close Nipple into the other compressed air inlets on the bottom of the Air Knife.

STEP 2 – Install the Model 900735 ½ NPT female Cross onto Model 900736 ½ x ¼ NPT Reducer and tighten. Be sure the ½ NPT female connections are directed toward the ends of the Air Knife.

STEP 3 – Install Model 900734 ½ x ½ x ¼ NPT female Pipe Tees onto the 9551 ¼ NPT Close Nipples and tighten. Make sure the outlets are oriented (as shown above) along the length of the knife.

STEP 4 – Hand tighten (2) Model 900733 ½ NPT x ½ Hose Barbs into the Model 900734 ½ x ½ x ¼ NPT female Pipe Tees opposite the side where the plant compressed air will be supplied and on both sides of the remaining Model 900734 ½ x ½ x ¼ NPT female Pipe Tees. On the Model 900735 ½ NPT female Cross at the center of the Air Knife, hand tighten (2) Model 900733 ½ NPT x ½ Hose Barbs into the inlets that point towards the end of the knife.

- STEP 5** – Determine the length of hose that is necessary by measuring from outside the yellow collar of the one Barb fitting to outside the yellow collar on the opposite fitting. For a tight hose, cut the hose to this exact length. (Increasing the hose length will result in a loose hose).
- STEP 6** – Remove hand tightened Barb fittings and push the hose onto the Hose Barbs. You may use a glycerin based lubricant such as soap (not included). **DO NOT USE AN OIL BASED LUBRICANT TO INSTALL THE FITTINGS.**
- STEP 7** – Install and tighten the ½ NPT male ends of the hose into the Model 900734 ½ NPT female Tee and Model 900735 ½ female NPT Cross. Install Model 900622 ½ MNPT x ¼ FNPT Reducer in the remaining inlet on Model 900735 ½ female NPT Cross.
- STEP 8** – Model 9011 Pressure Gauge has been provided to monitor the pressure at the Air Knife. You may choose to install it or the Model 2527 Pipe Plug into the remaining ¼ NPT female connection of Model 900622 Reducer. Your Air Knife is now ready for installation. **Please note that you will need to supply compressed air to each ½ NPT inlet at the ends of the air knife.**

If you have any questions or problems, please contact:

YOUR INFO HERE:

Company Name

Telephone

FAX:

Email:

Website:



Manufacturing Intelligent Compressed Air Products Since 1983

11510 Goldcoast Drive, Cincinnati, OH, USA 45249-1621

(513) 671-3322 FAX (513) 671-3363 Email: techhelp@exair.com

MODEL 9079 UNIVERSAL AIR KNIFE PLUMBING KIT **INSTALLATION & MAINTENANCE**

This Model 9079 Universal Air Knife Plumbing Kit is used to interconnect the compressed air inlets on the bottom of any Air Knife with a length over 84" (2134mm). The components of this kit have been sized appropriately to obtain best performance from the Air Knife (maintain uniform airflow across the entire length).

The Model 9076 Universal Air Knife Plumbing Kit should be used for lengths from 24" (610mm) - 42" (1067mm). The Model 9077 Universal Air Knife Plumbing Kit should be used for lengths from 42" (1067mm) - 54" (1372mm). The Model 9078 Universal Air Knife Plumbing Kit should be used for lengths from 60" (1524mm) - 84" (2134mm). Air Knives less than 24" (610mm) can be supplied at one compressed air inlet. See Lit 2111 and 2112 for Stainless Steel Air Knife Plumbing Kits.

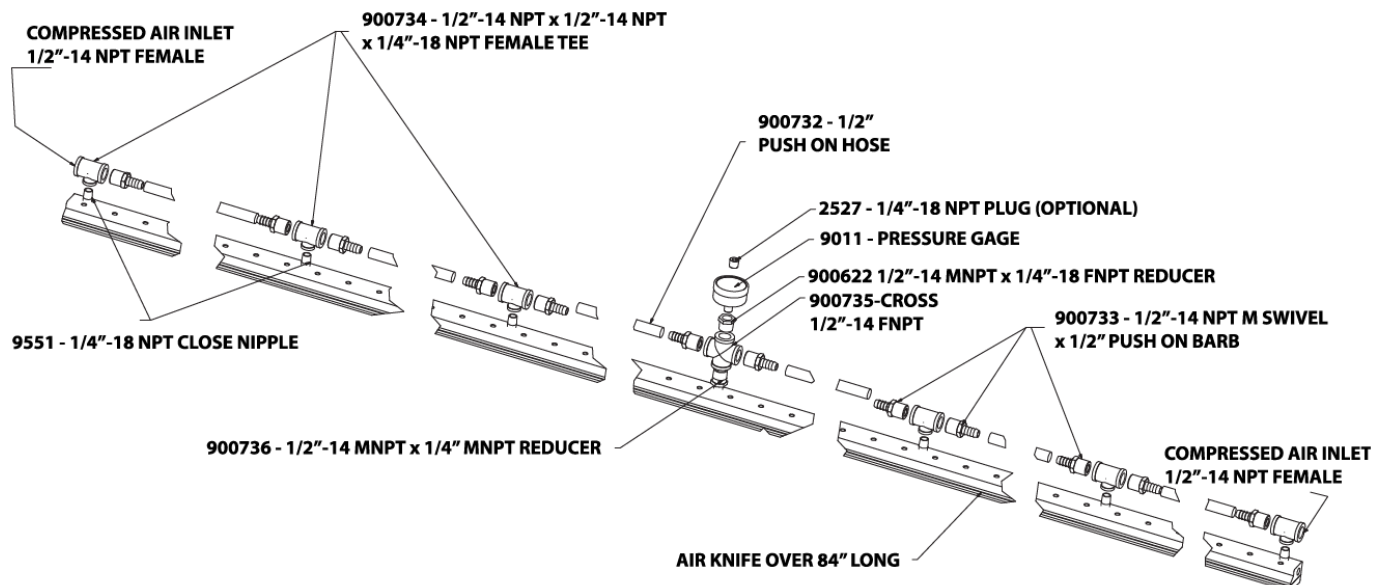

Pipe thread sealant should be applied to all threads (small packet included). Avoid the inside diameter of the fitting so it does not enter into the Air Knife.

STEP 1 – In the center inlet, install Model 900736 ½ MNPT x ¼ MNPT Reducer. Install Model 9551 ¼ NPT Close Nipples into the other compressed air inlets on the bottom of the Air Knife.

STEP 2 – Install the Model 900735 ½ NPT female Cross onto Model 900736 ½ x ¼ NPT Reducer and tighten. Be sure the ½ NPT female connections are directed toward the ends of the Air Knife.

STEP 3 – Install Model 900734 ½ x ½ x ¼ NPT female Pipe Tees onto the Close Nipples and tighten. Make sure the outlets are oriented (as shown above) along the length of the knife.

STEP 4 – Hand tighten (2) Model 900733 ½ NPT x ½ Hose Barbs into the Model 900734 ½ x ½ x ¼ NPT female Pipe Tees opposite the side where the plant compressed air will be supplied and on both sides of the remaining Model 900734 ½ x ½ x ¼ NPT female Pipe Tees. On the Model 900735 ½ NPT female Cross at the center of the Air Knife, hand tighten (2) Model 900733 ½ NPT x ½ Hose Barbs into the inlets that point towards the end of the knife.

- STEP 5** – Determine the length of hose that is necessary by measuring from outside the yellow collar of the one Barb fitting to outside the yellow collar on the opposite fitting. For a tight hose, cut the hose to this exact length. (Increasing the hose length will result in a loose hose).
- STEP 6** – Remove hand tightened Barb fittings and push the hose onto the Hose Barbs. You may use a glycerin based lubricant such as soap (not included). **DO NOT USE AN OIL BASED LUBRICANT TO INSTALL THE FITTINGS.**
- STEP 7** – Install and tighten the ½ NPT male ends of the hose into the Model 900734 ½ NPT female Tee and Model 900735 ½ female NPT Cross. Install Model 900622 ½ MNPT x ¼ FNPT Reducer in the remaining inlet on Model 900735 ½ female NPT Cross.
- STEP 8** – Model 9011 Pressure Gauge has been provided to monitor the pressure at the Air Knife. You may choose to install it or the Model 2527 Pipe Plug into the remaining ¼ NPT female connection of Model 900622 Reducer. Your Air Knife is now ready for installation. **Please note that you will need to supply compressed air to each ½ NPT inlet at the ends of the air knife.**

If you have any questions or problems, please contact:

YOUR INFO HERE:

Company Name

Telephone

FAX:

Email:

Website: